

THE R K P WEAR CLIP FOR JD 1700 & ME5 GAUGE WHEEL ARMS

With the introduction of the John Deere 1700 Series planter in 1998 a new stop mechanism for the gauge wheel arms was created. This new stop pivoted such that as one arm hit the stop it forced other arm down. This change created the problem of additional wear on the gauge wheel arms at the contact point.

In response to This problem R K Products has created a "wear clip" that provides a hardened surface, protecting the arm.

The clip fits over the arm securely at the contact point between the gauge wheel stop and the arm. The clip is designed to be easy to install and can be reversed once wear makes it necessary.

We recommend filling the divot from the depth stop with weld or a JB Weld type product and grinding the area flat prior to installing the clips.

Worn Arm

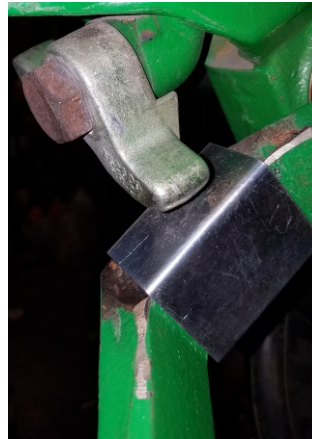

Repaired arm

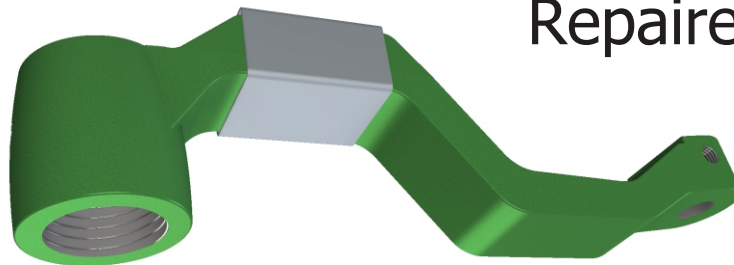

\$5 / Wear Clip